

EXCELDirect Power Vent[®]

EXCELDirect Power Vent is the essential solution to pressurized direct vent systems. Ideal for direct vent appliances with a power termination or an in-line fan. It is listed to a 550° F (288°C) temperature rating, while other brands are listed at 400°F (204.4°C). The positive seal is achieved with the high temperature silicone gasket on the inside and an O-ring for the outer pipe. Which means it has the tightest seals on the market.

The 3/5 pipe fits easier in tight spaces. Locking bands make the pipe rigid after installation and no twist lock means you can adjust the fitting to meet your installation requirements. No taping joints, no lubricants on the pipe and no sealants are required. Just fast, easy, clean assembly.

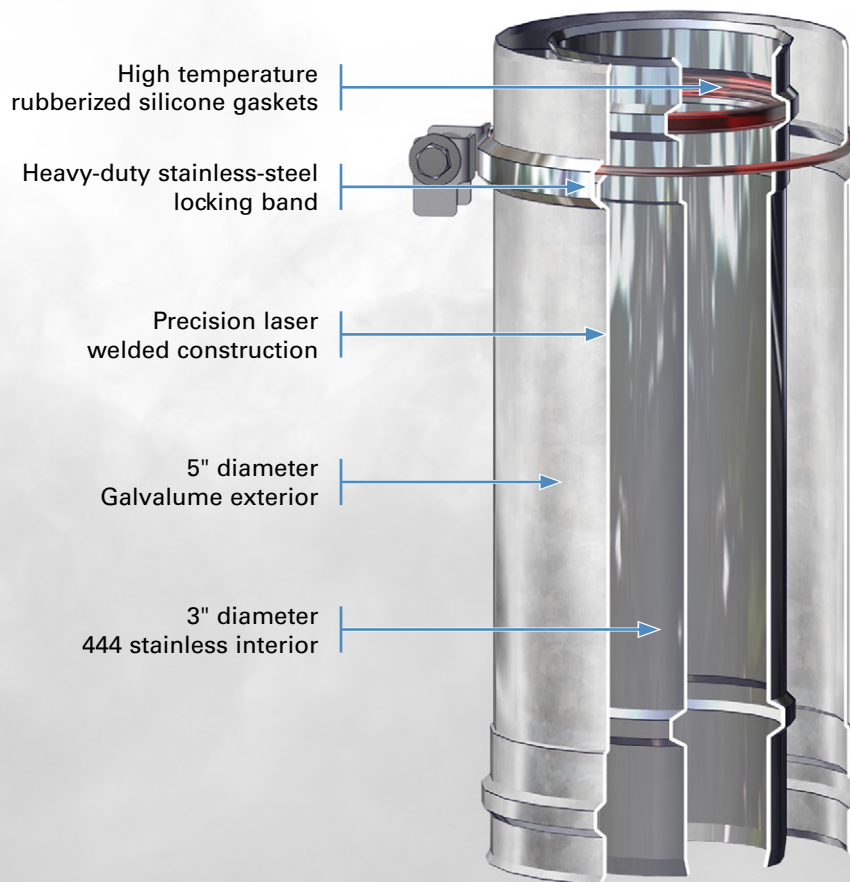

EXCELDirect Power Vent® Technical Information

Construction

Inner Liner: 0.019" Type 444 Stainless Steel

Outer Casing: 0.019" Galvalume Steel

Gaskets: High-Temperature Silicone

Sizes

3 1/4" Inner Liner Diameter

5" Outer Casing Diameter

5 3/8" Outer Casing Expanded Diameter

Allowable Flue Gas Temperatures

UL 1738 550° F (288°C) temperature rating
+ 70° F (38.8°C) for ambient temperature

EXCELDirect Power Vent® Design Considerations

Prior to starting your installation, we suggest you take the following into consideration:

1. There are two general ways to connect a direct vent venting system to a gas appliance:
 - Horizontal installation (through the wall)
 - Vertical installation (through the roof).
 - i. Check the appliance manufacturer's installation instructions to see all vent configurations.
2. Review all your options for the appliance location and venting configuration. Try to minimize the alteration and reframing of structural components of the building (wall studs, water pipes, electrical wiring, ceiling joists, roof rafters, etc.). It may be easier to change the location of your appliance than to modify the building structure.
3. Carefully read the appliance and the venting system instruction manuals. Good planning might save you time, work, and money.
4. Use only authorized EXCELDirect Power Vent® listed parts unless compatibility with another brand is specified in the appliance manufacturer's instructions. Do not use damaged parts.
5. For a horizontal installation, consider the distance between the gas appliance adapter and the wall, the wall thickness, and a vertical rise (if applicable).
6. The exterior horizontal vent termination must be located as per Installation Codes and Regulations. For USA and Canadian Termination Installation Clearances, refer to Table 3 on page 21 of the *EXCELDirect Power Vent® POWER VENT VENTING SYSTEM INSTALLATION AND MAINTENANCE INSTRUCTIONS*.
7. For a vertical installation, you must consider the distance between the gas appliance outlet and the ceiling, the ceiling thickness, the height between floors, and allow sufficient vent height above the roof line. For vent height requirements, refer to Table 1 and Figure 8 on page 13 of the *EXCELDirect Power Vent® POWER VENT VENTING SYSTEM INSTALLATION AND MAINTENANCE INSTRUCTIONS*.
8. For multi-story applications, firestops are required on each floor. Additional lengths and elbows will be required if an offset is needed in the attic.
9. Contact your local building authority and/or fire officials for permits, restrictions, and installation inspections. You may also wish to contact your house insurance representative.
10. Any sealants used must be used within their marked time limitations.

EXCELDirect Power Vent® Typical Installations

Planning your installation

Examples of Power Vent Horizontal and Vertical Installations

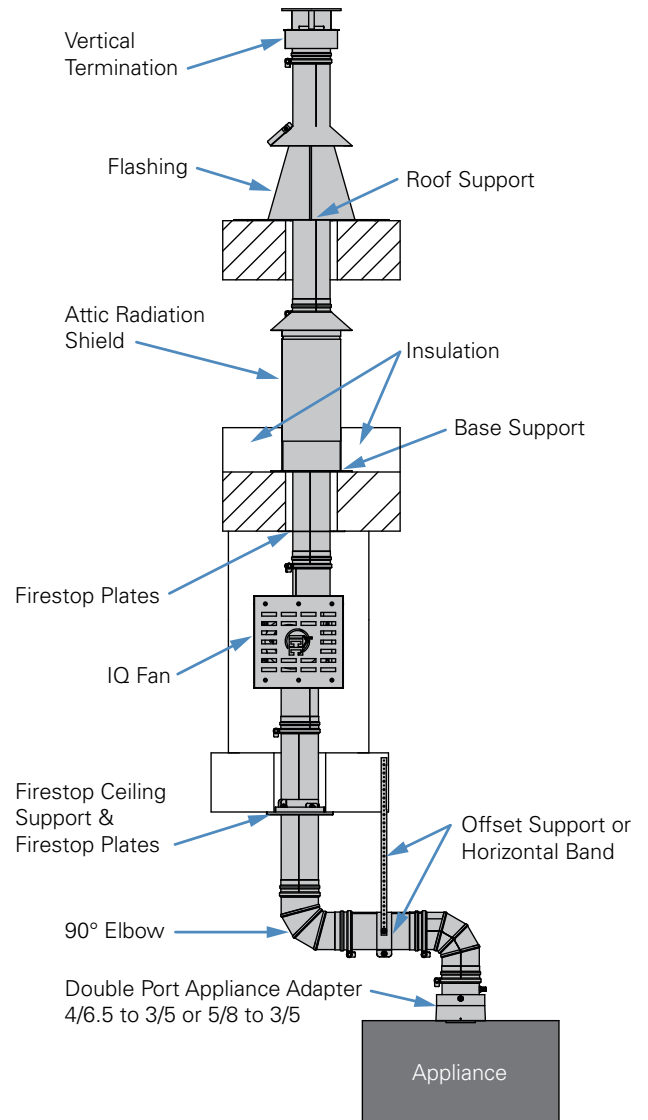
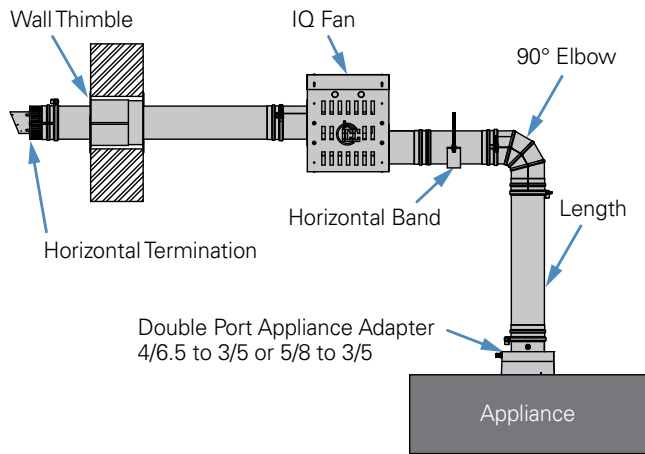

EXCELDirect Power Vent® Product Descriptions

Lengths

(35DPL6, 35DPL1, 35DPL2, 35DPL3, 35DPL4)

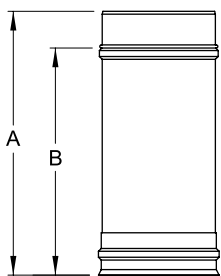

EXCELDirect Power Vent® lengths are available in 48", 36", 24", 12" & 6". All lengths have a stainless steel interior and a Galvalume exterior. A locking band is included with every length.

INCHES

Dimensions		
Code	A	B
35DPL6	5 3/4	4
35DPL1	11 3/4	10
35DPL2	23 3/4	22
35DPL3	35 3/4	34
35DPL4	47 3/4	46

Slip Lengths

(35DPLS1, 35DPLS2)

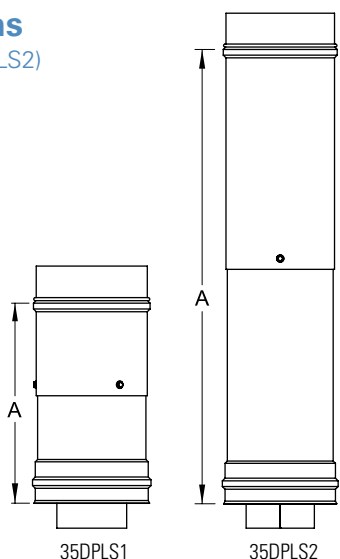

Slip lengths enable an installer to adjust the venting system to the exact overall length required for any installation. Slip lengths must be installed above a straight length that is not adjustable and will not adjust into an elbow. A locking band is included. Optional: Silicone caulking roll.

INCHES

Dimensions		
Code	A Min	A Max
35DPLS1	6 1/8	9
35DPLS2	12 1/8	21

12" Length with Drain

(35DPLD)

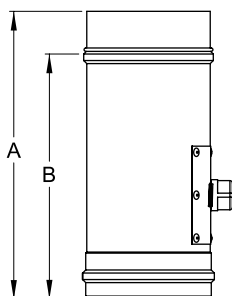

If an appliance manufacturer's instruction or local code requires a drain, then a 12" Length with Drain (LD) may be installed either horizontally or vertically. Refer to the appliance or power vent manufacturer's installation instructions for requirements concerning drainage. A locking band is included.

INCHES

Dimensions		
Code	A	B
35DPLD	11 3/4	10

*3/4 NPT drain port

Elbows 45° & 90°

(35DPE45, 35DPE90)

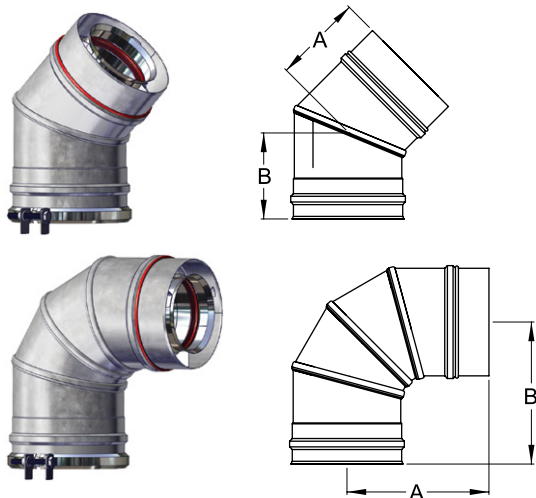

An offset will be required if the vent cannot pass directly above the appliance. EXCELDirect Power Vent® elbows are available in 45° and 90°. The outer casing is Galvalume. The stainless steel inner casings are seam welded to ensure there is no leakage. A locking band is included with each elbow.

Code	Dimensions	
	A	B
35DPE45	4 1/8	4
35DPE90	6 5/8	6 5/8

INCHES

Base Support

(35DPBS)

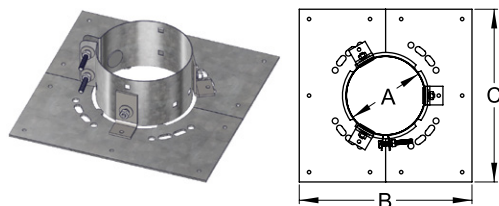

The Base Support (BS) is the most common type of support installed and it can be used on any floor level, including non-combustible flooring. Vertically, it can support up to 40' of vent duct. The BS can also be used to support horizontal runs of venting. A FireStop Plate (FSP) comes with the Base Support.

Code	Dimensions		
	A	B	C
35DPBS	5	11	11

INCHES

Wall Support

(35DPWS)

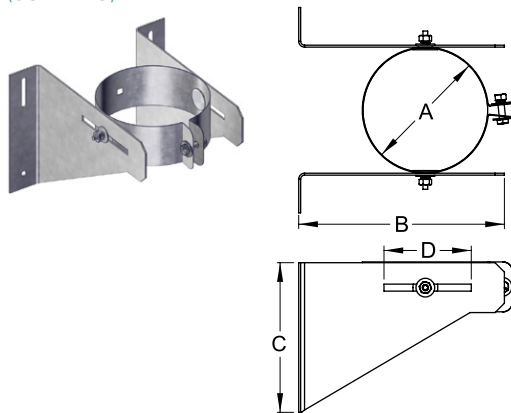

For vent runs passing parallel to a wall, a Wall Support (WS) can reinforce vents that run 3 3/8" to 6 7/8" from the wall to the center of the vent. The wall support can support up to 30' of vent duct.

Code	Dimensions			
	A	B	C	D
35DPWS	5	8 1/4	6	3 1/2

INCHES

Offset Support

(35DPOS)

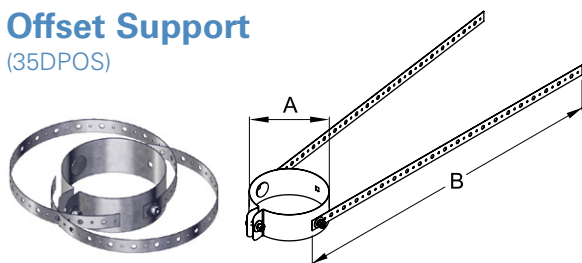

Use an Offset Support (OS) to reinforce a vertical vent run and to avoid placing excessive stress on elbows. The OS can also be used to support horizontal runs of venting.

Code	Dimensions	
	A	B
35DPOS	5	24

INCHES

Roof Support

(35DPSR)

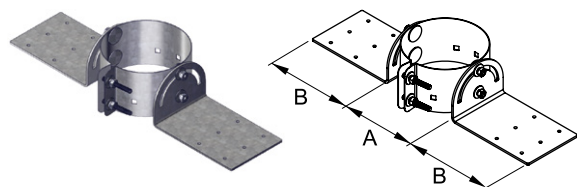

The Roof Support (SR) is designed to reinforce a vent length on a flat or an inclined surface. The SR can support up to 30' of venting. It can be installed so the collar is on the outside of the roof or so that it is set inside of the roof hole. Firestop Plates (FSP) are not required on the roof level but may be added for additional support.

INCHES			
Dimensions			
Code	A	B	
35DPSR	5	6 1/8	

Firestop Ceiling Support

(35DPFS)

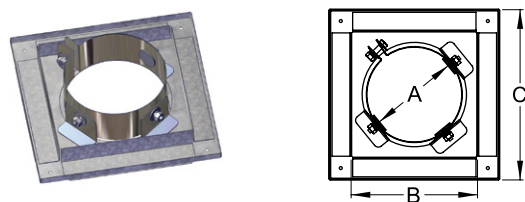

The Firestop Ceiling Support (DPFS) is the perfect choice when a structure hides the venting system. It is designed to be used in wood frame construction and can be used on any floor level. It acts as a firestop and supports the vent from below the door. It can also be installed above the joists, however, in this case, an additional firestop is required from below. The DPFS can support up to 30' of venting. A FireStop plate (FSP) comes with the Firestop Ceiling Support.

INCHES			
Dimensions			
Code	A	B	C
35DPFS	5	6 5/8	9

Firestop Plates

(35DPFSP)

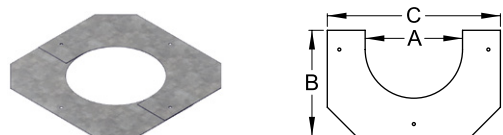

The Firestop Plate (FSP) consists of two identical half-circular parts. They are required on every ceiling (from below) or wall (interior and exterior) to prevent air and water flow between rooms or floors. They are not required at the roof level. EXCELDirect Power Vent® offers different firestop supports to fit all applications.

INCHES			
Dimensions			
Code	A	B	C
35DPFSP	5	5 1/2	9

Horizontal Band

(35DPHB)

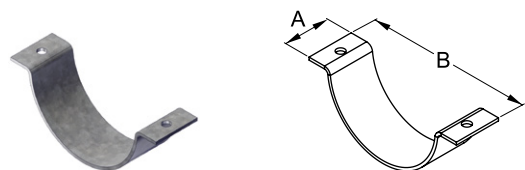

The Horizontal Band (HB) is a half band made of galvanized steel designed to support the vent when it travels horizontally. The maximum distance between Horizontal Bands is 10'. Typically, 1/4" diameter or larger threaded rods and fasteners (not supplied) are used to attach the band to the ceiling structure. Plumber strapping or any other hanging materials with a rating of 500 lbs or more may also be used.

INCHES			
Dimensions			
Code	A	B	
35DPHB	2	7	

Attic Radiation Shield

(35DPAS)

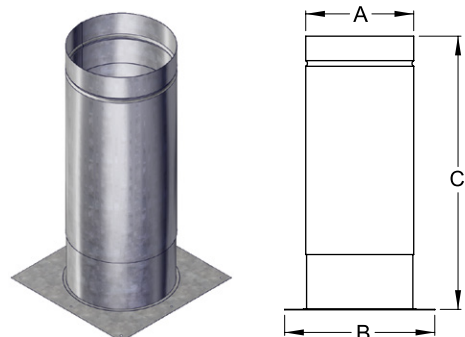

The Attic Radiation Shield (AS) is installed on the top of the floor level and is used when the venting system is not enclosed in an attic space. The height is adjustable from 17 3/8" to 32". A minimum of a 1" overlap is required. Fix the height using the provided self-tapping screws. No sealant is needed. The Attic Radiation Shield includes a Storm Collar (SC).

INCHES			
Dimensions			
Code	A	B	C
35DPAS	7 7/8	11	16 - 28

Wall Thimble (35DPWT)

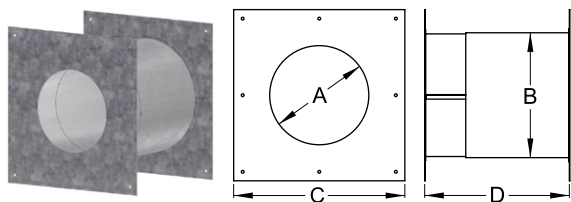

Telescopes to accommodate wall thickness from 5 3/4" to 10 1/2". The PWTI is fully insulated and fits tightly to prevent heat loss. Two FireStop plates come with the Wall Thimble (PWT) and the Insulated Wall Thimble (PWTI).

Dimensions					INCHES
Code	A	B	C	D	
35DPWT	5 1/2	6 7/8	9 1/2	5 3/4 - 10 1/2	
35DPWTI	5 1/2	6 7/8	9 1/2	5 3/4 - 10 1/2	

*The wall thimble can be adjusted to fit the thickness of a thinner wall, refer to the installation manual

Insulated Wall Thimble (35DPWTI)

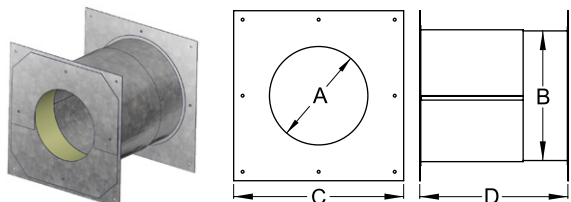

Locking Band (35DPLB)

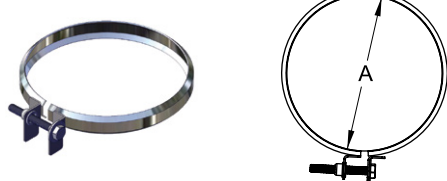

The Locking Band (LB) is designed to overlap the flange and bead immediately above and below the chimney joint. It is secured using a 7/16" nut driver.

Dimensions		INCHES
Code	A	
35DPLB	5	

Horizontal Termination (35DPHT)

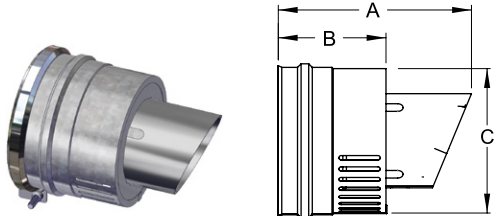

Our Horizontal Termination (PHT) is made of Galvalume outer casing, stainless steel inner casing and tested to high wind conditions. A locking band is included with the PHT. Refer to the manufacturer's installation instructions will provide restrictions regarding maximum and minimum vent runs, the number of elbows and the relationship between lengths of vent run to vent rise.

Dimensions				INCHES
Code	A	B	C	
35DPHT	6 3/4	3 3/4	5	

Vertical Termination (35DPVT)

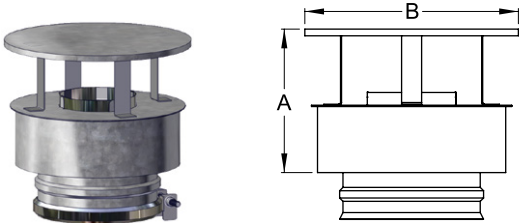

Our Vertical Termination (PVT) is made of Galvalume outer casing, stainless steel inner casing and tested to high wind conditions. It is certified to high wind applications where the vent terminates vertically. It cannot be installed horizontally. A locking band is included with the PVT.

Dimensions			INCHES
Code	A	B	
35DPVT	5 3/8	8	

Flashings

(35DPF, 35DPFA, 35DPFB)

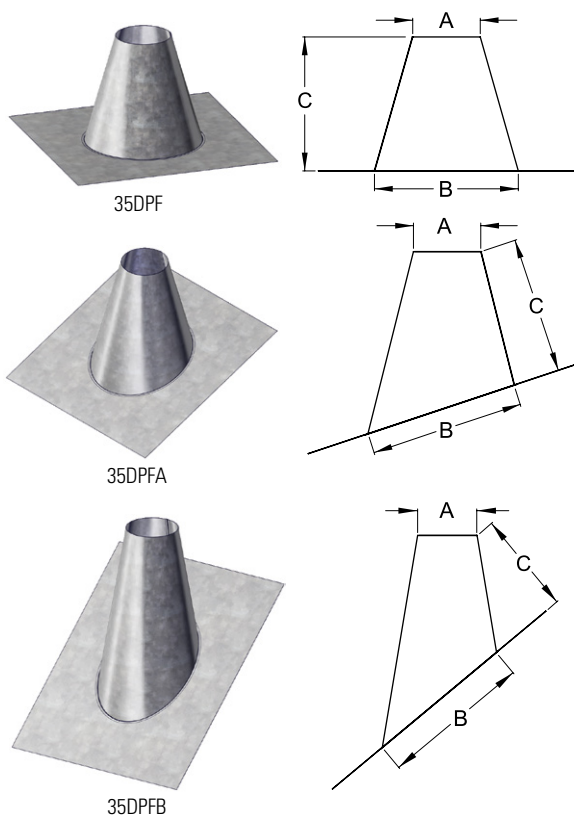

Our Flashings are made of galvalume steel and we have variations to fit various pitches. Vented (VF, VFA, VFB) and non-vented (F, FA, FB) flashings are available. Flashings include a Storm Collar (SC)

INCHES

Dimensions					
Code	Pitch	Base W x L	A	B	C
35DPF	Flat - 2/12	21 x 21	5 1/2	11 3/4	11
35DPFA	1/12 - 7/12	23 x 23	5 1/2	12 5/8	11 1/4
35DPFB	8/12 - 12/12	21 x 26	5 1/2	13 7/8	9 1/2

Storm Collar

(35DPSC)

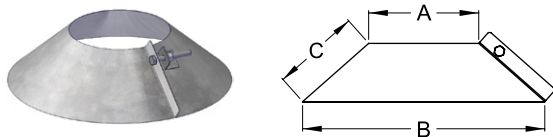

Our Storm Collars (SC) are made of galvalume steel and are required to be used in combination with EXCELDirect Power Vent® regular and vented flashings as well as the Attic Radiation Shield. Storm collars should be sealed with silicone sealant to prevent water from seeping in and down the venting.

INCHES

Dimensions			
Code	A	B	C
35DPSC	5	11	4

Fan Intake Adapter

(35DPFIA)

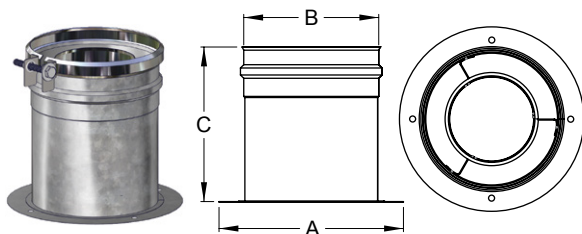

The Fan Intake (FIA) Adapter is ideal in tight spaces. It connects the vent Length (L) directly to the 3" x 5" power vent fan inlet. For an end of line power vent fan, inline fan, only the Fan Intake Adapter (FIA) is required. The adapter is screwed to the power vent fan using the self-tapping screws provided. The joint must be sealed using silicone sealant applied on the inside bottom end of the inner liner and the bottom ring. Sealant not included. A locking band is included with the FIA. You can use this part when space is tight to attach to the fan inlet.

INCHES

Dimensions			
Code	A	B	C
35DPFIA	7	5	5 7/8

Fan Outlet Adapter

(35DPFOA)

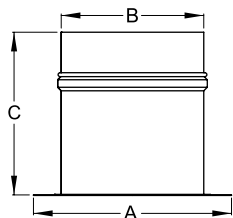
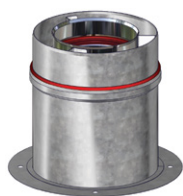

The Fan Outlet (FOA) is ideal for tight spaces. It connects the vent Length (L) directly to the inline 3" x 5" power vent fan outlet. The adapter is screwed to the power vent fan using the self-tapping screws provided. The joint must be sealed using silicone sealant applied on the inside bottom end of the inner liner and the bottom ring. Sealant not included. You can use this part when space is tight to attach to the fan outlet.

Dimensions			
Code	A	B	C
35DPFOA	7	5	5 3/4

INCHES

ICC/CVS Female Adapter

(35DPFAD)

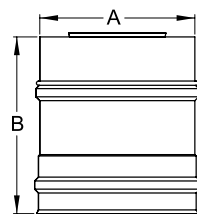

The Universal Female (Intake) Adapter (FAD) connects EXCELDirect Power Vent® to a certified manufacturers' appliance or fan inlet. The FAD transitions EXCEL Power Vent to Duravent CVS® on the fan's inlet side. The FAD is secured using the adapter locking bands. Two locking bands (LB) are included. Silicone (not included) is required to seal the joints. Refer to the appliance manufacturer's installation instructions for more information on Power Vent Fans and their required electrical connections.

Dimensions		
Code	A	B
35DPFAD	5	5 3/4

INCHES

CVS/ICC Male Adapter

(35DPMAD)

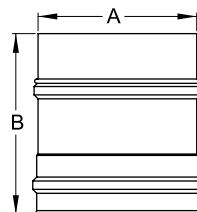

The Universal Male (Outlet) Adapter (MAD) connects EXCELDirect Power Vent® to a certified manufacturers' appliance or fan outlet. The MAD transitions from EXCEL Power Vent to Duravent CVS® on the fan's outlet side. The MAD is secured using the adapter locking bands. Two locking bands (LB) are included. Silicone (not included) is required to seal the joints. Refer to the appliance manufacturer's installation instructions for more information on Power Vent Fans and their required electrical connections.

Dimensions		
Code	A	B
35DPMAD	5	5 3/4

INCHES

Increaser 3/5 to 4/6.5

(35DPI34)

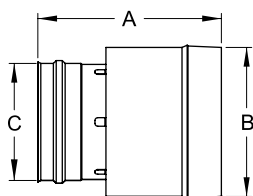
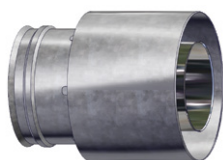

Designed to increase the diameter of a 3/5" Power Vent system to a 4 x 6.5" Direct Vent system.

Dimensions			
Code	A	B	C
35DPI34	8	6 1/2	5

INCHES

Increaser 3/5 to 5/8

(35DPI35)

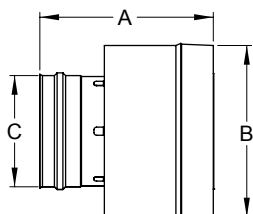
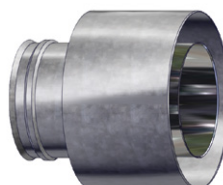

Designed to increase the diameter of a 3/5" Power Vent system to a 5/8" Direct Vent system.



Dimensions			
Code	A	B	C
35DPI35	8	7 7/8	5

INCHES

Adapter 4/7 to 3/5

(35DPR43NP, 35DPR43SP, 35DPR43DP)

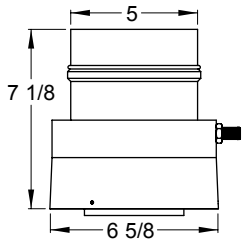

The EXCELDirect Power Vent® appliance adapter is permitted with approved manufacturer appliances. For certified manufacturer sample port requirements refer to the manufacturer's installation instructions. There is also a **Manufacturer specific appliance adapters listing** at the end of this section. This adapter replaces other adapters supplied with the appliance. Available with or without the sample port.

Power Vent Appliance Adapters / Reducers			
4/7 to 3/5 Appliance Adapter			
No Port (DPR43NP)	Single Port (DPR43SP)	Double Port (DPR43DP)	
			
35DPR43NP has no ports	35DPR43SP has one port	35DPR43DP has two ports	
Refer to the Manufacturer specific appliance adapters listing at the end of this section.			

Adapter 5/8 to 3/5

(35DPR53NP, 35DPR53SP, 35DPR53DP)

The EXCELDirect Power Vent® appliance adapter is permitted with approved manufacturer appliances. For certified manufacturer sample port requirements refer to the manufacturer's installation instructions. There is also a **Manufacturer specific appliance adapters listing** at the end of this section. This adapter replaces other adapters supplied with the appliance. Available with or without the sample port.

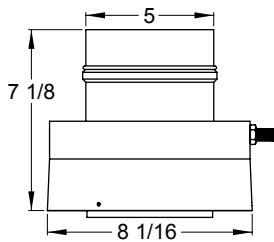
Power Vent Appliance Adapters / Reducers			
5/8 to 3/5 Appliance Adapter			
No Port (DPR53NP)	Single Port (DPR53SP)	Double Port (DPR53DP)	
			
35DPR53NP has no ports	35DPR53SP has one port	35DPR53DP has two ports	
Refer to the Manufacturer specific appliance adapters listing at the end of this section.			

EXCELDirect Power Vent® Certified Manufacturer Listing

EXCELDirect Power Vent® Appliance and Fan Adapters		
Certified Manufacturer	Appliance Adapters	Fan Adapters
Ortal Fireplaces	35DPR43SP	
	35DPR53SP	
Urbana Fireplaces, Sherwood Industries Ltd.	35DPR43NP	35DPI34
	35DPR53NP	